

TOOLING

Product	Page
Pipe and Tube Flaring Equipment	167
Pipe Benders:	169
782 - Pipe and Tube Bender	169
885 - Triangle Pipe Bender	170
1085 - Large Pipe and Tube Bender	171



Bar Hydraulics offers tools for use with all of our product lines in many industries. We can provide tooling for pipe bending, flaring, cutting, deburring, pressure testing, flushing and oil analysis to name a few. Bar Hydraulics tools are engineered for point of use to work directly with the Bar Hydraulic offering of industrial, marine and mobile products. Bar Hydraulics tools are packaged in kits that can be sold or rented by customers from any one of our global locations.

BAR HYDRAULICS TOOLS INCLUDE:

- Pipe and tube cold cut saws
- Flaring tools capable of 10°, 37° and 90° from ¼" – 10"
- Bending tools from ¼" – 6" pipe
- Flushing and pressure test rigs
- Oil testing equipment

Bar Hydraulics tools are engineered with our customers in mind. All Bar Hydraulics tools are designed to increase efficiency and reduce installation costs.



PIPE AND TUBE FLARING EQUIPMENT FOR **BARCONN**® AND **BARDKO**® CONNECTION

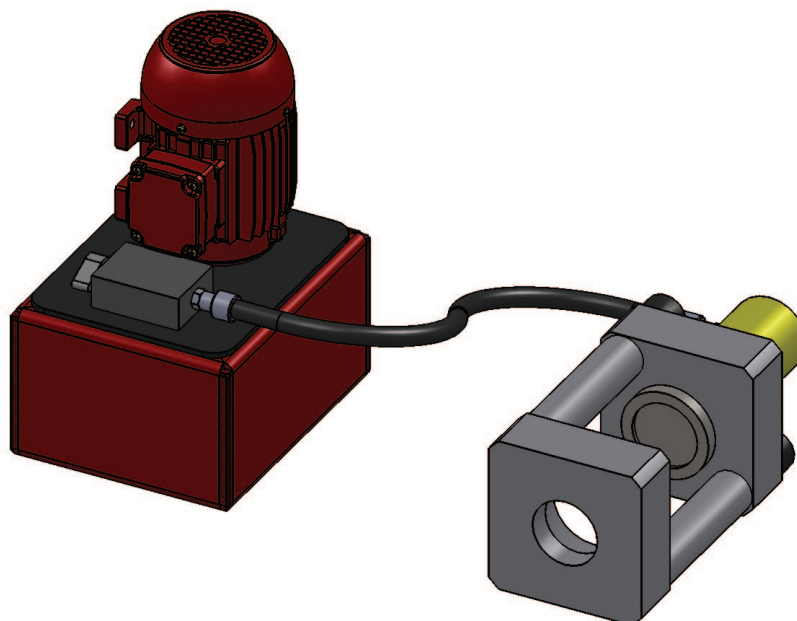

Type	BCM332R (½" - 2")	BCM380 (½" - 5")	BCM3160 (½" - 10")
Flaring Tool for machine pre-assembly of BARCONN and BARDKO cones for tubes and pipes includes power pack and hose assembly.	BCM332RPPHA	BCM380PPHA	BCM3160PPHA
Flaring tool without power pack and hose assembly. Device for a connection to a power pack. PA = max. 700 bar V = min 3l with plug-in connection coupling. Weight: 100kg	BCM332R	BCM380	BCM3160
Power Pack (110 VAC Electrical pump unit)	BCM332RPP	BCM332RPP	BCM332RPP
Hose assembly 6 ft. c/w quick disconnect coupling rated for 10,000psi (690 bar)	BCM332RHA	BCM332RHA	BCM332RHA

FLARING TOOL DIES FOR **BARCONN®** AND **BARDKO®** CONNECTION

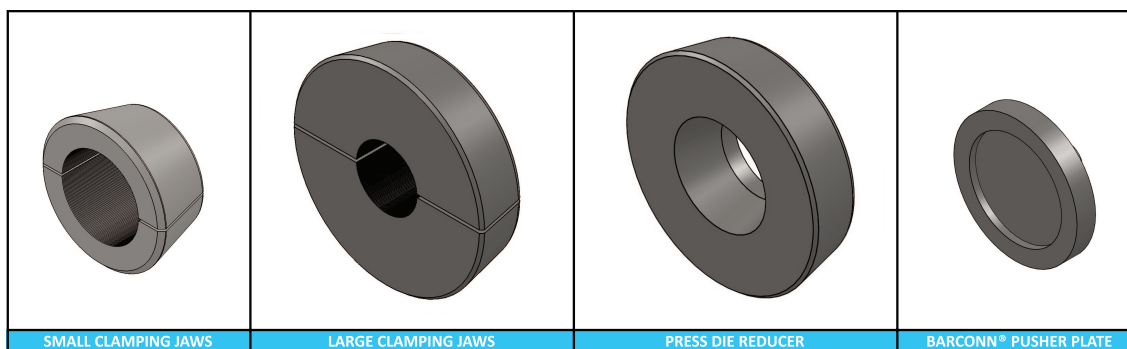

BARCONN® FLARING DIES			
Tube O.D. (mm)	Small Clamping Jaws	Large Clamping Jaws	BARCONN® Pusher Plate
16	BC016	---	BCP016
20	BC020	---	BCP020
25	BC025	---	BCP025
30	BC030	---	BCP030
38	BC038	---	BCP038
42	BC042	---	BCP042
60	BC060	---	BCP060
65	BC065	---	BCP065
80	---	BCD080	BCP080
88	---	BCD088	BCP088
114	---	BCD114	BCP114
141	---	BCD141	BCP141
219	---	BCD219	BCP219
273	---	BCD273	BCP273

* All parts carbon steel*

FLARING DIE REDUCER	
Size	Part No.
Medium	BCRP380
Large	BCRP3160

* All parts carbon steel*

BARDKO® FLARING DIES		
		
Tube Size (OD x WT)	Pusher Rod	Clamp Jaws
8 x 1.5	BKP8X1.5	BKD08
8 x 2	BKP8X2	BKD08
10 x 1.5	BKP10X1.5	BKD10
10 x 2	BKP10X2	BKD10
12 x 2	BKP12X2	BKD12
16 x 2	BKP16X2	BKD16
16 x 3	BKP16X3	BKD16
20 x 2	BKP20X2	BKD20
20 x 3	BKP20X3	BKD20
25 x 3	BKP25X3	BKD25
25 x 4	BKP25X4	BKD25
30 x 3	BKP30X3	BKD30
30 x 4	BKP30X4	BKD30
30 x 5	BKP30X5	BKD30
38 x 4	BKP38X4	BKD38
38 x 5	BKP38X5	BKD38

* All parts carbon steel*

782 Pipe and Tube Bender and Shoe Groups

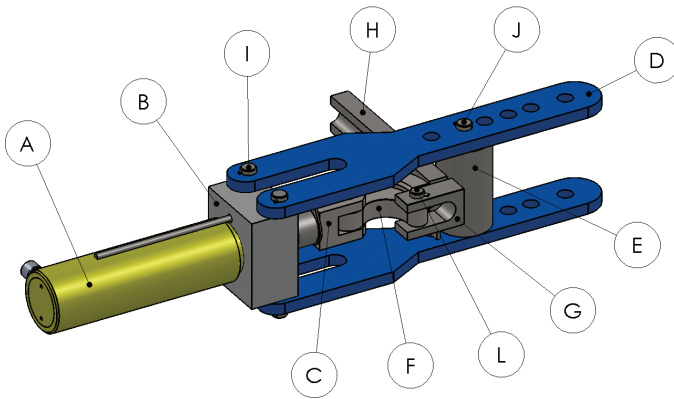

Purchase shoe groups individually to bend up to 90° bends in tubing with actual outside diameters of 3/4" to 2 1/2" tubing.

782 PARTS:

Key	Part #	Description	Qty
A	13251	Hydraulic Ram	1
B	13252	Mounting Block	1
C	69800	Yoke (c/w ruler)	1
D	11083	Connecting Arm	2
E	14094	Roller	1
F	-	Shoe (see chart below)	1
G	-	Clevis (see chart below)	1
H	-	Follow Bar (see chart below)	1
I	13252	Arm Pin (c/w spring clips)	2
J	14496	Roller Pin (c/w spring clip)	1
K	40860	Yoke Pivot Pin	1
L	29370	Clevis Pin	1

782 SHOE GROUPS FOR TUBE/PIPE:

For brass, copper, steel and aluminum tubing with 1/16" (1.6mm) minimum wall thickness. (Not for use with chrome moly tube.) Also 3/4" through 1 1/2" O.D. bendable stainless steel tubing with wall thickness from 0.065" to 0.150".

Part	Description
BHB-782	30 Ton tube/pipe bender <i>without</i> hydraulic pump or shoe groups.

SPECIFICATIONS

Capacity: Up to 2 3/4" (60mm) diameter.

Power Source: 120 VAC Electric Hydraulic Pump (farm duty).

Weight: 124 lbs (56.2 kg).

OPTIONS

BHB-WS7: Steel work stand for 782 bender.

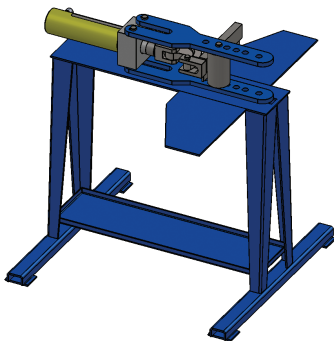

	Size	O.D. (in)	Group*	Shoe	Fol. Bar	Clevis
IMPERIAL TUBE	3/4"	0.750	TUG-3	11151	14280	16444
	1"	1.000	TUG-5	11142	11117	16403
	1 1/4"	1.250	TUG-7	11160	11124	16414
	1 1/2"	1.500	TUG-9	11149	11129	16416
	2"	2.000	TUG-13	11155	11109	11071
IMPERIAL PIPE	1/2"	0.840	PIG-3	21151	24280	26444
	3/4"	1.050	PIG-5	21142	21117	26403
	1"	1.315	PIG-7	21160	21124	26414
	1 1/4"	1.660	PIG-9	21149	21129	26416
	1 1/2"	1.900	PIG-11	21155	21109	21071
	2"	2.370	PIG-13	21157	21111	21073
METRIC TUBE	16mm	0.629	MPG-1	31140	34278	36442
	20mm	0.787	MPG-3	31151	34280	36444
	30mm	1.181	MPG-7	31160	31124	36414
	38mm	1.496	MPG-9	31149	31129	36416
	42mm	1.653	MPG-11	31150	31130	36417
	50mm	1.968	MPG-13	31155	31109	31071
	60mm	2.362	MPG-15	31157	31111	31073

* Shoe group includes: Bending Shoe, Follow Bar and Clevis

885 Triangle Pipe Bender for One-Shot 90°s in 2³/₄" - 4" (Segments in 5")

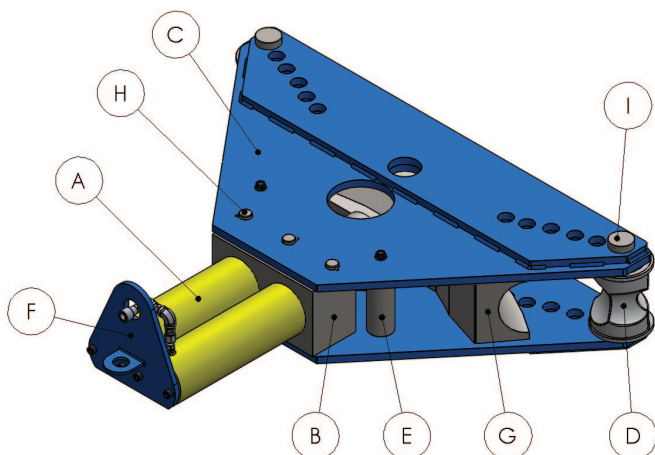

- Strong, portable, pin-assembled, aluminum and steel components
- Easy to use ram travel scale and charts for accurate bends.
- Make elbows, offsets and saddles.
- 885 bends one-shot 90°s in 2³/₄" - 4" (segments in 5") pipe.

Key	Part #	Description	Qty
A	16752	Hydraulic Ram	2
B	16754	Mounting Block	1
C	11289	Triangle Frame	2
D	15671	Mandrel	2
E	33454	Frame Support Rod	1
F	50302	Cylinder Support Plate	1
G	-	Bending Shoe (<i>See Below</i>)	1
H	10946	Frame Pin	3
I	19811	Mandrel Pin	2
J	16753	Bending Shoe Pin	1

Part	Description
BHB-885	2 ³ / ₄ " through 4" one-shot and 5" segment rigid pipe bender <i>without</i> hydraulic pump.
BHB-885E980	2 ³ / ₄ " through 4" one-shot and 5" segment rigid pipe bender with electric hydraulic pump.

885 BENDING RADIUS

Pipe Size	Bending Radius
80mm	13"
88mm	15 ³ / ₄ "
114mm	20"
141mm	28"

SPECIFICATIONS

Capacity: Up to 5" (141mm) diameter.

Power Source: 120 VAC Electric Hydraulic Pump (farm duty).

Weight: 449 lbs (203.6 kg).

BENDING SHOES

Pipe Size	O.D. (in)	Shoe No.
80mm	3.150	10923
88mm	3.464	10924
114mm	4.488	14265
141mm	5.551	15669

1085 Large Pipe and Tube Bender and Shoe Groups

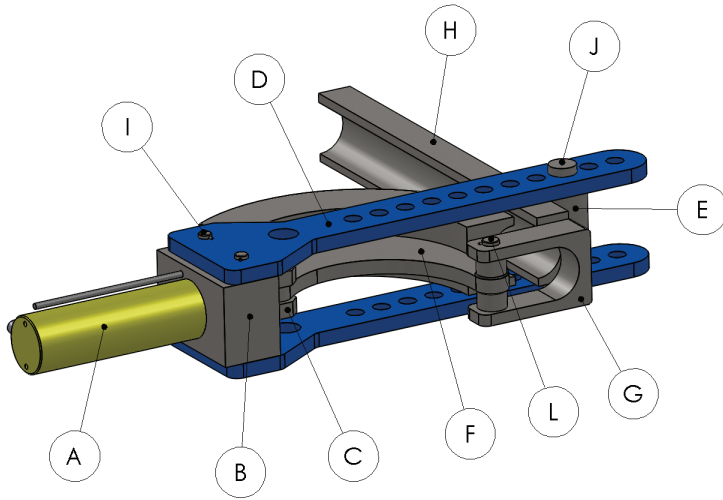

Purchase shoe groups individually to bend up to 90° bends in tubing and piping with actual outside diameters of ¾" to 4½" tubing.

1085 PARTS:

Key	Part #	Description	Qty
A	16752	Hydraulic Ram	1
B	50302	Mounting Block	1
C	10698	Yoke (c/w ruler)	1
D	11083	Connecting Arm	2
E	14094	Roller	1
F	-	Shoe (see chart below)	1
G	-	Clevis (see chart below)	1
H	-	Follow Bar (see chart below)	1
I	13252	Arm Pin (c/w spring clips)	2
J	14496	Roller Pin (c/w spring clip)	1
K	10408	Yoke Pivot Pin	1
L	29937	Clevis Pivot Pin	1

1085 SHOE GROUPS FOR TUBE/PIPE:

For brass, copper, steel and aluminum tubing with ⅛" (1.6mm) minimum wall thickness. (Not for use with chrome moly tube.) Also ¾" through 1½" O.D. bendable stainless steel tubing with wall thickness from 0.065" to 0.150".

Part	Description
BHB-1085	50 Ton tube/pipe bender <i>without</i> hydraulic pump or shoe groups.

SPECIFICATIONS
Capacity: Up to 4½" (114mm) diameter.
Power Source: 120 VAC Electric Hydraulic Pump (farm duty).
Weight: 221 lbs (100.2 kg).

	Size	O.D. (in)	Group*	Shoe	Fol. Bar	Clevis
IMPERIAL TUBE	¾"	0.750	TUG-3	11151	14280	16444
	1"	1.000	TUG-5	11142	11117	16403
	1½"	1.250	TUG-7	11160	11124	16414
	1½"	1.500	TUG-9	11149	11129	16416
	2"	2.000	TUG-13	11155	11109	11071
IMPERIAL PIPE	½"	0.840	PIG-3	21151	24280	26444
	¾"	1.050	PIG-5	21142	21117	26403
	1"	1.315	PIG-7	21160	21124	26414
	1½"	1.660	PIG-9	21149	21129	26416
	1½"	1.900	PIG-11	21155	21109	21071
	2"	2.370	PIG-13	21157	21111	21073
	3"	3.500	PIG-15	21159	21113	21075
	4"	4.500	PIG-17	21161	21115	21077
METRIC TUBE	20mm	0.787	MPG-3	31151	34280	36444
	25mm	0.984	MPG-5	31142	31117	36403
	30mm	1.181	MPG-7	31160	31124	36414
	38mm	1.496	MPG-9	31149	31129	36416
	42mm	1.653	MPG-11	31150	31130	36417
	50mm	1.968	MPG-13	31155	31109	31071
	60mm	2.362	MPG-15	31157	31111	31073
	65mm	2.550	MPG-17	31158	31112	31074
	80mm	3.140	MPG-19	31156	31110	31072
	88mm	3.460	MPG-21	31159	31113	31075
	114mm	4.480	MPG-22	31161	31115	31077

* Shoe group includes: Bending Shoe, Follow Bar and Clevis

NOTES

BAR FLARE
SYSTEM

PIPE & TUBE

CLAMPS

VALVES

ADAPTERS

HOSES &
COUPLINGS

O-RINGS

BLOCKS

TOOLING